

QUICK GUIDE

- HOW TO USE THE PROGRAM SELECTION/PROGRAM MANAGER

This quick guide describes how to use the Program selection/Program manager. Program selection is found as the last step in the Fitting wizard. The Program manager is found under Fine tuning. The functionality is the same for Program selection and Program manager.

The CLEAR440 always starts up with a Master program. More programs can easily be added in the Program Selection/Program manager.

There are two categories of programs, normal programs and compound programs. With normal programs, the same program is selected for the left and right hearing aid. Compound programs are a combination of a Master program in one hearing aid and another program in the other hearing aid.

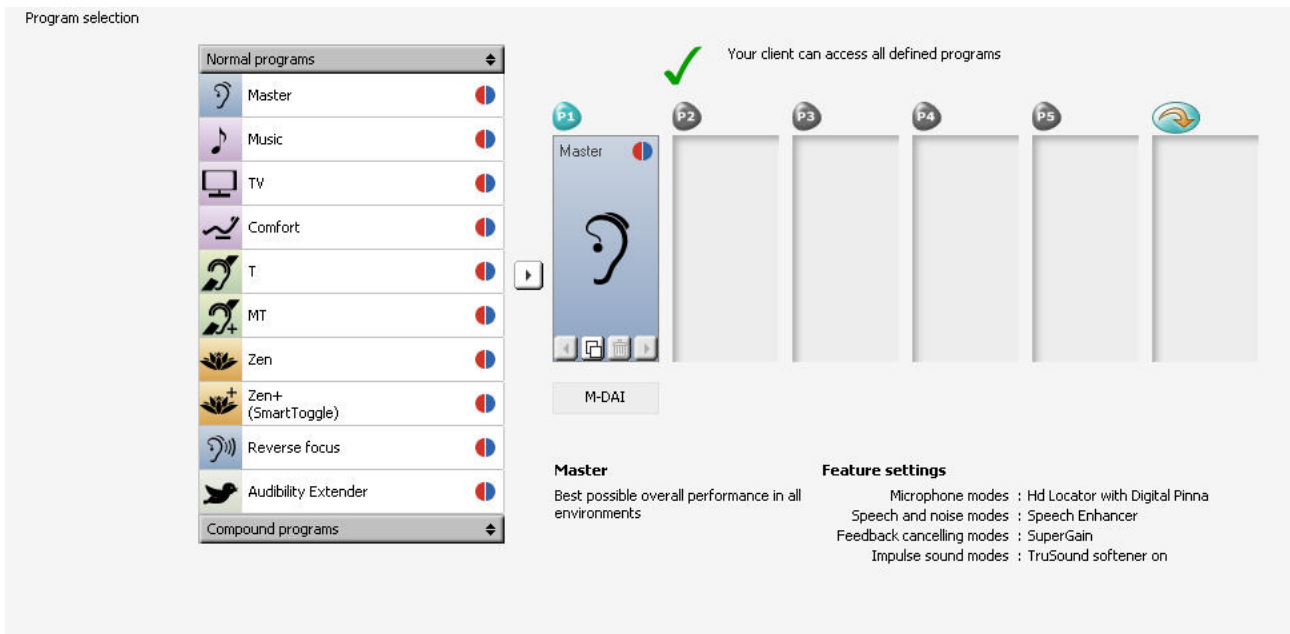

Double click on the program that you want to add, and the program is added in the hearing aids.

To delete a program click the icon with a bin. 

To make a copy of a program click the icon with two squares. 

To change the program order, use the arrows. 